

Spring Pin (For General Purpose)

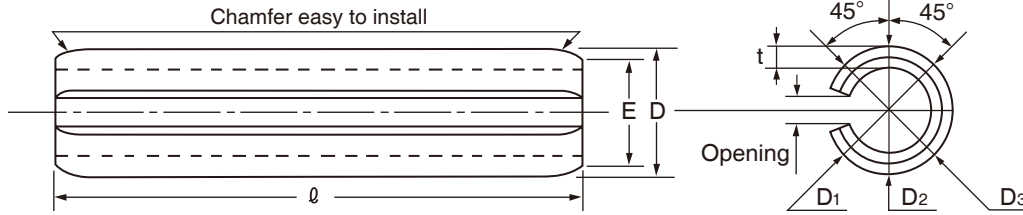

The clearance C must have dimensions that do not allow contact of the sides of the Pin as inserted into the applicable hole.



l	1-10	11-30	31-50	51-70	71 or over
h	0,2 or under	0,3 or under	0,4 or under	0,5 or under	0,6 or under

Unit: mm

Nominal dia.		1	1.2	1.5	1.6	2	2.5	3	3.5	4	4.5	5	6	8	10	12	13	
Dimension	D	Max.	1.2	1.4	1.7	1.8	2.25	2.75	3.25	3.84	4.4	4.84	5.4	6.4	8.6	10.6	12.5	13.7
		Min.	1.1	1.3	1.6	1.7	2.15	2.65	3.15	3.7	4.2	4.7	5.2	6.2	8.3	10.3	12.3	13.4
	t	Basic	0.2	0.25	0.3	0.3	0.4	0.5	0.6	0.7	0.8	0.9	1	1.2	1.6	2	2	2.5
	E	Max.	0.9	1.1	1.4	1.5	1.9	2.4	2.9	3.4	3.9	4.3	4.8	5.8	7.8	9.8	11.7	12.7
Groove dimension	Diameter		1	1.2	1.5	1.6	2	2.5	3	3.5	4	4.5	5	6	8	10	12	13
	Tol.		+0.08 0			+0.09 0			+0.12 0				+0.15 0		+0.2 0			

Length (l)		Nominal dia.																
Basic	Tol.	1	1.2	1.5	1.6	2	2.5	3	3.5	4	4.5	5	6	8	10	12	13	
4	+0.5 0	○	○	○	○	○	○											
5		○	○	○	○	○	○			○								
6		○	○	○	○	○	○	○	○	○								
8		○	○	○	○	○	○	○	○	○	○	○	○	○				
10	+1 0	○	○	○	○	○	○	○	○	○	○	○	○	○				
12		○	○	○	○	○	○	○	○	○	○	○	○	○	○			
14			○	○	○	○	○	○	○	○	○	○	○	○	○			
15			○	○	○	○	○	○	○	○	○	○	○	○	○			
16				○	○	○	○	○	○	○	○	○	○	○	○	○		
18					○	○	○	○	○	○	○	○	○	○	○	○	○	
20						○	○	○	○	○	○	○	○	○	○	○	○	○
22							○	○	○	○	○	○	○	○	○	○	○	○
24								○	○	○	○	○	○	○	○	○	○	○
25									○	○	○	○	○	○	○	○	○	○
26	+1 0							○	○	○	○	○	○	○	○	○	○	
28									○	○	○	○	○	○	○	○	○	
30										○	○	○	○	○	○	○	○	
32											○	○	○	○	○	○	○	
35												○	○	○	○	○	○	
36													○	○	○	○	○	
38														○	○	○	○	
40															○	○	○	
45																○	○	
50																	○	
55	+1.5 0																○	
56																	○	
60																	○	
63																	○	
65																	○	
70																	○	
75																	○	
80																	○	
85																	○	
90																	○	
95																○		
100																○		
110																○		
120																○		
130																○		
140																○		

Material = Carbon spring steel Finish = Phosphate coating (ACP) Hardness = 40 through 50HRC (40 through 50HRC only for Nominal dia. 13mm)
 Material = Stainless steel for spring (SUS304-CS) Finish = N/A

Notes

1. Max. D shall be the maximum value on the circumference of the pin. Min. D shall be the average of the D1, D2, and D3 diameter values.
2. Contact us for products having lengths other than the ○ marked dimensions.
3. ○ marks stand for the dimensions of products of carbon spring steel. The dimensions of products of stainless steel may not be manufactured. Contact us.
4. Our products with little marketability may not be in stock. When employing our products, consult with us for their availability.

RETAINING RINGS | PUSH NUTS | WAVE WASHERS AND OTHERS | SCREW TYPE PLATE NUTS | SPRING PINS | SNAP PINS | JOINT CLIPS | ASSEMBLY TOOLS

Spring Pin (For Light Duty)

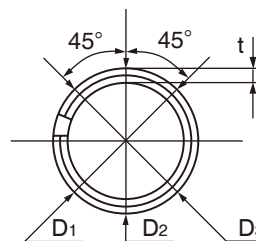
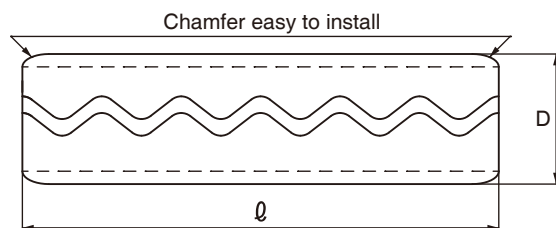

Unit: mm

Nominal dia.		1.6	2	2.5	3	4		
Spring Pin	D	Max.	1.8	2.25	2.75	3.25	4.4	
		Min.	1.7	2.15	2.65	3.15	4.2	
t			0.15	0.2	0.25	0.3	0.4	
Groove dimension			1.6 $\begin{matrix} +0.08 \\ 0 \end{matrix}$	2 $\begin{matrix} +0.09 \\ 0 \end{matrix}$	2.5 $\begin{matrix} +0.09 \\ 0 \end{matrix}$	3 $\begin{matrix} +0.09 \\ 0 \end{matrix}$	4 $\begin{matrix} +0.12 \\ 0 \end{matrix}$	
Length (ℓ)	5	+0.5 0	○	○				
	6			○		○		
	8		○	○	○	○	○	
	10		○	○	○	○	○	
	12	○		○	○	○	○	
	14			○		○		
	16			○	○	○		
	18			○	○	○		
	20			○		○		
	22	+1 0			○	○		
	25				○	○	○	
	28						○	○
	30						○	
	32						○	
36						○		

Material = Stainless steel for spring

Notes

1. Max. D shall be the maximum value on the circumference of the pin. Min. D shall be the average of the D1, D2, and D3 diameter values.
2. Contact us for products having lengths other than the ○ marked dimensions.
3. Our products with little marketability may not be in stock. When employing our products, consult with us for their availability.