

Bowed E-Ring

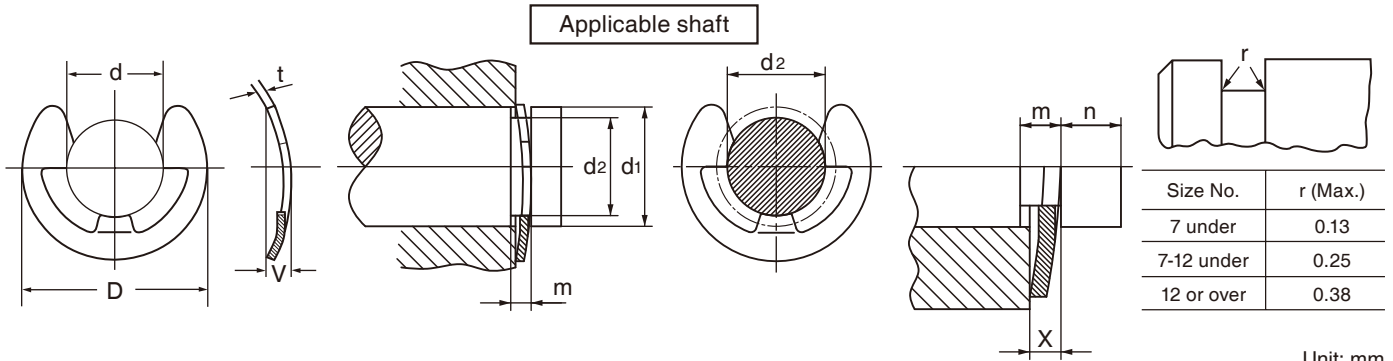

Size No.	Retaining rings					Applicable shaft								
	d	D	t	V		d1		d2		m		X		n
				Basic	Tol.	Min.	Max.	Basic	Tol.	Basic	Tol.	Min.	Max.	
BETW- 1.5	1.5	4	0.4	0.8	+0.15	2	2.5	1.53	+0.06	0.8	+0.1	0.55	0.65	0.8
2	2	5	0.4	0.8		-0.1	2.5	3.2		2.05		0.8	0.55	0.65
2.5	2.5	6	0.4	0.8	+0.25	3.2	4	2.55	0	0.8	0	0.55	0.65	1
3	3	7	0.6	1.1		4	5	3.05		1.1		0.85	1	1
4	4	9	0.6	1.1	0	5	7	4.05	+0.075	1.1	0	0.85	1	1.2
5	5	11	0.6	1.1		6	8	5.05		1.1		0.85	1	1.2
6	6	12	0.8	1.3	+0.4	7	9	6.05	0	1.3	0	1	1.2	1.2
7	7	14	0.8	1.3		8	11	7.1		1.3		1	1.2	1.5
8	8	16	0.8	1.3	0	9	12	8.1	+0.09	1.3	0	1	1.2	1.8
9	9	18	0.8	1.3		10	14	9.1		1.3		1	1.2	2
10	10	20	1	1.7	+0.4	11	15	10.15	0	1.7	0	1.3	1.6	2
12	12	23	1	1.7		13	18	12.15		1.7		1.3	1.6	2.5
15	15	29	1.5	2.3	+0.6	16	24	15.15	0	2.3	0	1.8	2.2	3

Material = Carbon spring steel Hardness = 40 through 50HRC, Finish = Zinc Plate plus Chromate

Notes

Our products with little marketability may not be in stock. When employing our products, consult with us for their availability.

C-Ring

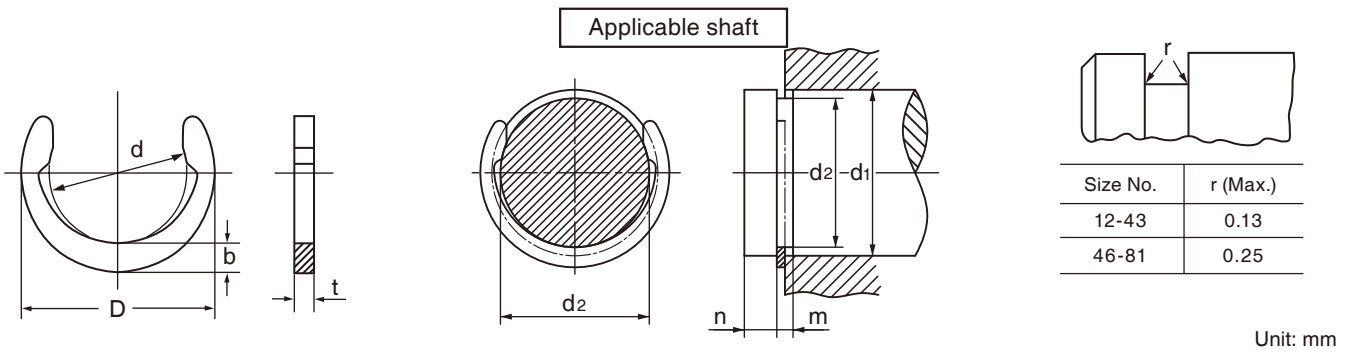

Size No.	Retaining rings					Applicable shaft						
	d		D	b	t	d1	d2		m		n	
	Basic	Tol.					Basic	Tol.	Basic	Tol.		Min.
5103- 12	2.59	+0.05	4.17	0.79	0.4	3.2	2.69	0.48	+0.04	0.8		
18	4.09	-0.1	6.19	1.05	0.4	4.8	4.19	0.48	0	0.9		
21	4.75	+0.07	6.99	1.12	0.6	5.6	4.9	0.7	+0.06	1.1		
25	5.36		7.9	1.27	0.6	6.4	5.59	0.7		1.2		
31	6.86	-0.13	9.56	1.35	0.6	7.9	7.01	0.7	0	1.3		
37	8.33		11.37	1.52	0.6	9.5	8.51	0.7		1.5		
40	9.12	±0.15	12.32	1.6	0.6	10.3	9.25	0.7	0	1.6		
43	9.8		13.1	1.65	0.6	11.1	9.98	0.7		1.7		
46	10.54	±0.18	14	1.73	0.6	11.9	10.69	0.7	0	1.8		
50	11.2		14.76	1.78	0.9	12.7	11.43	1		1.9		
56	12.62	±0.08	16.56	1.98	0.9	14.3	12.88	1	0	2.1		
81	18.31		23.23	2.46	1.4	±0.06	20.6	18.59		1.5	3	

Material = Carbon spring steel Hardness = 44 through 52HRC, Finish = Zinc Plate plus Chromate

Notes

- Our products with little marketability may not be in stock. When employing our products, consult with us for their availability.
- When requesting stock products, specify them. (5103-81 available only as a bulk package)

RETAINING RINGS | PUSH NUTS AND OTHERS | WAVE WASHERS | SCREW TYPE PLATE NUTS | SPRING PINS | SNAP PINS | JOINT CLIPS | ASSEMBLY TOOLS